



Annular mini ringlight

Mini Ringlight

Features

- Continuous ring of illumination fiber within the housing.
- Mounts directly to objective by means of thumb screw.
- Optimized illumination of the mini ringlight only requires a comparably small fiber bundle diameter.
- Therefore the SCHOTT Mini Ringlight has an interchangeable adapter with removable ferrules, which allows the connection to all KL light sources.
- Manufactured in the EU.

Benefits

- Absolute shadow-free illumination.
- Small dimensions for easy handling.

| Mini Ringlight | | | | | | | | | |
|-------------------|----------|---------|------------|-----------|-----------|-----------|---------------------------|-----------------|-------------------|
| Cold light source | Part-No. | Type | Length | Inner Ø | Outer Ø | Height | Minimum working distance* | Active Ø/branch | Outer Ø jacketing |
| | | | L | ID | OD | H | A | b | D |
| KL 200 | 157 040 | Slit-RL | 1000 mm | 40 mm | 64 mm | 24 mm | 15 mm | 7 mm | 11.8 mm |
| KL 200 LED | | 40 mm Ø | 39.37 inch | 1.58 inch | 2.52 inch | 0.95 inch | 0.58 inch | 0.28 inch | 0.47 inch |
| KL 1500 LCD | | | | | | | | | |
| KL 1500 compact | | | | | | | | | |
| KL 1500 LED | | | | | | | | | |
| KL 2500 LCD | | | | | | | | | |

* Ringlight usable in any working distance above given minimum values.

Product improvements may result in specification or feature changes without notice.

Mini Ringlight

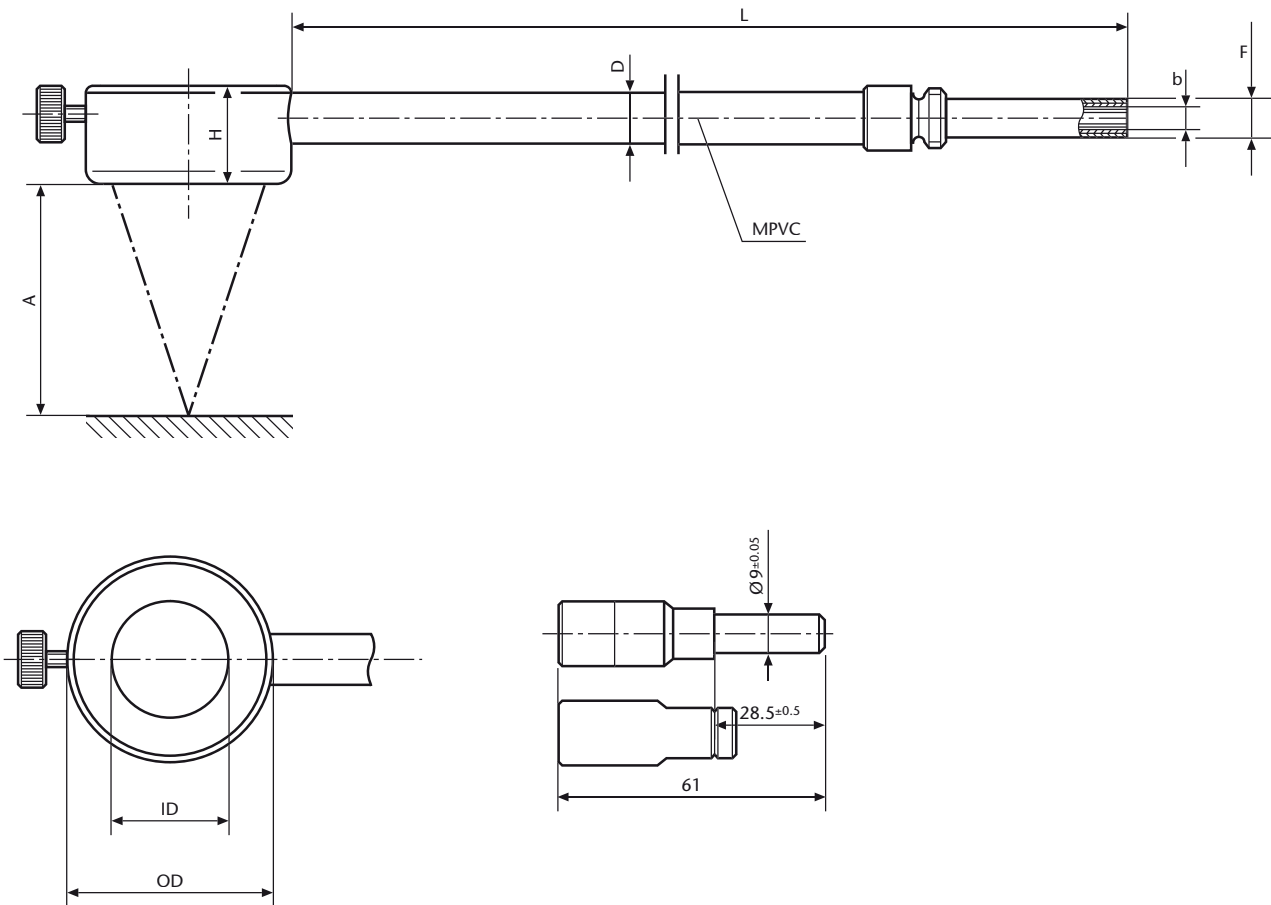

Lighting and Imaging
SCHOTT North America, Inc.
122 Charlton Street
Southbridge, MA 01550-1960
USA

Phone: +1 508/765-9744
Fax: +1 508/764-6273
lightingimaging@us.schott.com
www.us.schott.com/lightingimaging

For your local sales contact please visit
www.us.schott.com/lightingimaging

SCHOTT
glass made of ideas