

SCHOTT® HelioLine

High-quality Aviation approved side-emitting glass fiber cable



SCHOTT® HelioLine sidelight components are side-emitting optical fibers that were developed to answer the high demand for mood- and ambient lighting in aircraft cabins. SCHOTT® HelioLine sidelight components offer a huge number of outstanding user benefits for line light applications including:

- Excellent color characteristics
- High light output and homogeneity in combination with SCHOTT® HelioBasic II, HelioIntense or HelioPower light sources
- Very limited space depth
- Non-electrical light emitters
- Perfect fluid resistance
- Excellent flexibility resulting in extreme small bending radii for more design freedom
- Unrivalled lifetime

Applications

Mood lighting and ambient illumination in aircraft cabin:

- Toe-Kick areas
- Table & monument edges
- Seat contours
- Steps of staircase
- Handrails

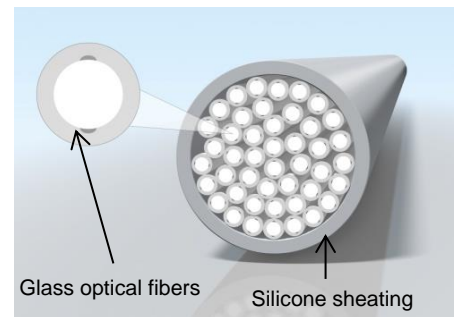

SCHOTT® HelioLine is a side-emitting cable with a silicone sheathing.

Version 05.2014



Technical Data SCHOTT® HelioLine

SCHOTT Part number	1470754	1470763
Dimensions :	∅ 2,0±0,1 mm	∅ 3,0±0,1 mm
Active bundle diameter	∅ 3,85±0,15 mm	∅ 4,85±0,2 mm
Cable diameter	> 10 mm	> 15 mm
Bending radius		
Weight	17 g/m	30 g/m
Glass fibers	approx. 670	approx. 1530
Quantity	70 µm	70 µm
Fiber diameter	max. 5 per meter allowed	
Fiber breakage	No conglomerates allowed	
Cable material	Silicon	
Color	White translucent	
Mounting and cleaning	No tensile stress or high pressure allowed	
Flammability	Bunsen burner test 60°-30s acc. FAR/JAR/CS25, App. F, Part I & AITM	
Smoke density	Acc. to JAR/FAR/CS25, App. F, Part V & AITM 2.0007 / 2.0008B	
Toxic Components	Acc. to ABD0031 & AITM 3.0005	
Fluids Susceptibility	According to RCTA DO-160F: Coffee, Soda, Alcoholic drinks, Isopropyl alcohol, Callington one shot (AMS1450)	
Chemical resistance	Good resistance against household cleaning agents as well as Ethanol. Other cleaning agents have to be tested.	
Light output uniformity and color deviation	Up to fiber length of 5.5 m no difference visible for lightsources with radiation angle of 55° max. (equals NA 0.46). For lengths > 2 m, lightsource at each end is highly recommended.	
Operating Conditions	Ambient Temperature Relative Humidity	-40°C to + 160°C 85% max.
Transportation and Storage	Temperature Relative Humidity	- 20°C to + 70°C 10 to 90% (non-condensing)

Related light sources

- SCHOTT® HelioBasic II (single color, standard intensity)
- SCHOTT® HelioIntense (single color, high intensity)
- SCHOTT® HelioIntense Spectrum CC (full colors, high intensity)
- SCHOTT® HelioPower (single color, very high intensity for multi-tail applications)

End ferrule with union nut

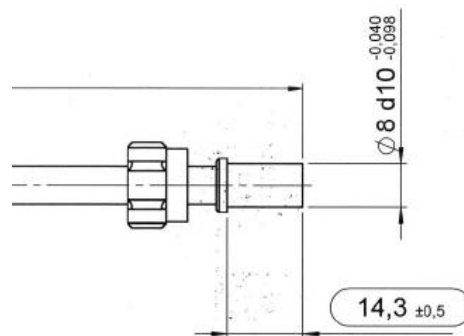

Version 05.2014