

Single Bundles

Flexible bundles give the user versatility when routing and positioning light.



Product and Performance Characteristics

- Variety of standard sizes with tight bending radius for easy routing
- Standard output ferrules accept spot lenses and polarizing caps (See the Accessories section)
- Standard input accepts Dichroic color filters, diffusers and ColdVision Series light sources
- Support products are available in the Support Apparatus section of the product catalog
- Modified standard and custom configurations are available

Bundle Input: Black Anodized Aluminium
 Bundle Sheathing: PVC Covered Metal Tubing

Single Bundle, A08020.60

Bundle Specifications

Part No.	Active Input Fiber Diameter	Distal Ferrule Diameter	Tubing Diameter	Bundle Length
A08020.40	.20" (5)	.393" (10)	.39" (10)	40" (1016)
A08020.60	.20" (5)	.393" (10)	.39" (10)	60" (1524)
A08025.40	.25" (6)	.393" (10)	.47" (12)	40" (1016)
A08025.60	.25" (6)	.393" (10)	.47" (12)	60" (1524)
A08031.40	.30" (8)	.393" (10)	.47" (12)	40" (1016)
A08031.60	.30" (8)	.393" (10)	.47" (12)	60" (1524)
A08031.80	.30" (8)	.393" (10)	.47" (12)	80" (2032)
A08051.40	.51" (13)	.625" (16)	.75" (19)	40" (1016)
A08051.60	.51" (13)	.625" (16)	.75" (19)	60" (1524)
A21200	.40" (10)	.507" (13)	.69" (18)	30" (762)

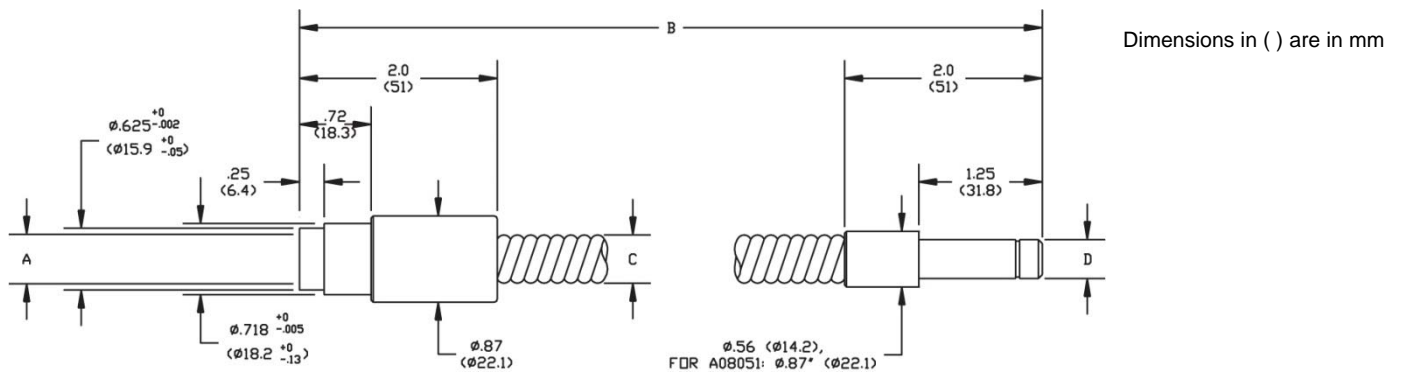

A08020.40 – A08051.60 Single Bundles



Matrix for A08020.40 - A08051.60 Bundles

Part No.	A	B	C	Bend Radius	D
A08020.40	.20" (5)	40" (1016)	.39" (10)	.5" (13)	.393" (10)
A08020.60	.20" (5)	60" (1524)	.39" (10)	.5" (13)	.393" (10)
A08025.40	.25" (6)	40" (1016)	.47" (12)	.6" (15)	.393" (10)
A08025.60	.25" (6)	60" (1524)	.47" (12)	.6" (15)	.393" (10)
A08031.40	.30" (8)	40" (1016)	.47" (12)	.6" (15)	.393" (10)
A08031.60	.30" (8)	60" (1524)	.47" (12)	.6" (15)	.393" (10)
A08031.80	.30" (8)	80" (2032)	.47" (12)	.6" (15)	.393" (10)
A08051.40	.51" (13)	40" (1016)	.75" (19)	1.4" (36)	.625" (16)
A08051.60	.51" (13)	60" (1524)	.75" (19)	1.4" (36)	.625" (16)
A21200	.40" (10)	30" (762)	.69" (18)	1.0" (25)	.507" (13)

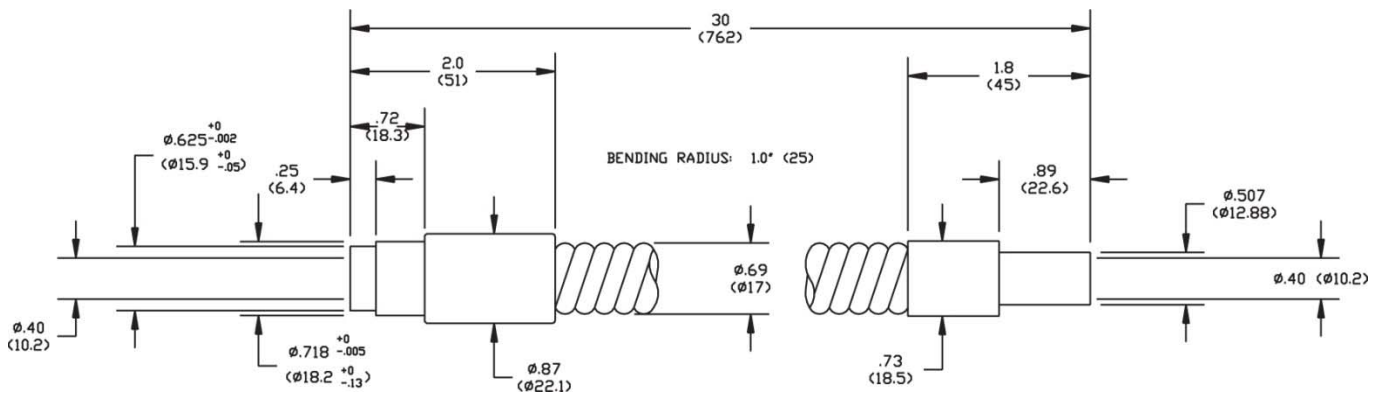

A21200 Bundle

Dimensions in () are in mm

Warning : This product is manufactured with glass fiber. Not for use in cable/hose carrier. Call SCHOTT to discuss moving cable/hose carrier applications.

All specifications are subject to change without prior notice. This datasheet or any extracts thereof may only be used in other publications with express permission of SCHOTT. © SCHOTT North America, Inc.

Lighting and Imaging
SCHOTT North America, Inc.
 122 Charlton Street
 Southbridge, MA 01550
 USA
 Phone: +1 (508) 765-9744
 Fax: +1 (508) 765-1299
 lightingimaging@us.schott.com
 www.us.schott.com/lightingimaging

