

Lightlines Support Apparatus

For accurate positioning in both industrial and laboratory environments.



3" Lightline, A08903, with Holder, A08901, supported by an articulated arm, A08506, and base, A08507



Lightline Holder, A08901

Part No.	Description
A08901	Custom Lightline holder with M6 thread. Will support 3" (76) to 10" (254) single lightlines when attached to an articulated arm and base.

Holder, A08901

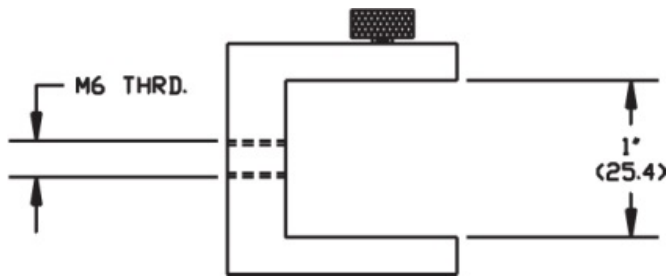

Quad Holder

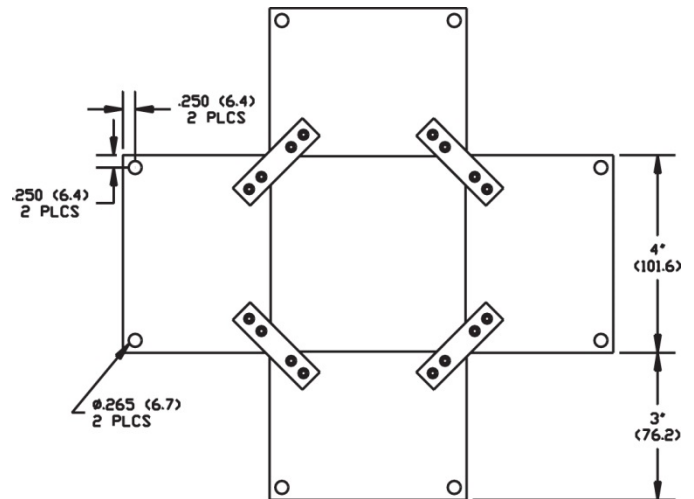

Dimensions in () are in mm

Version 01.2017

All specifications are subject to change without prior notice. This datasheet or any extracts thereof may only be used in other publications with express permission of SCHOTT. © SCHOTT North America, Inc.

Lighting and Imaging
SCHOTT North America, Inc.
 122 Charlton Street
 Southbridge, MA 01550
 USA
 Phone: +1 (508) 765-9744
 Fax: +1 (508) 765-1299
 lightingimaging@us.schott.com
 www.us.schott.com/lightingimaging

